

University of Nebraska - Lincoln

DigitalCommons@University of Nebraska - Lincoln

Nebraska Tractor Tests

Tractor Test and Power Museum, The Lester F.
Larsen

2013

Test 2073: Case IH Steiger 500 Quadtrac

Nebraska Tractor Test Lab

University of Nebraska-Lincoln, tractortestlab@unl.edu

Follow this and additional works at: <https://digitalcommons.unl.edu/tractormuseumlit>



Part of the [Energy Systems Commons](#), [History of Science, Technology, and Medicine Commons](#), [Other Mechanical Engineering Commons](#), [Physical Sciences and Mathematics Commons](#), [Science and Mathematics Education Commons](#), and the [United States History Commons](#)

Nebraska Tractor Test Lab, "Test 2073: Case IH Steiger 500 Quadtrac" (2013). *Nebraska Tractor Tests*. 2483.

<https://digitalcommons.unl.edu/tractormuseumlit/2483>

This Article is brought to you for free and open access by the Tractor Test and Power Museum, The Lester F. Larsen at DigitalCommons@University of Nebraska - Lincoln. It has been accepted for inclusion in Nebraska Tractor Tests by an authorized administrator of DigitalCommons@University of Nebraska - Lincoln.

NEBRASKA OECD TRACTOR TEST 2073 - SUMMARY 891

CASE IH QUADTRAC 500 DIESEL

16 SPEED

POWER TAKE-OFF PERFORMANCE

Power HP (kW)	Crank shaft speed rpm	Diesel Consumption Gal/hr (l/h)	lb/hp.hr (kg/kW.h)	Hp.hr/gal (kW.h/l)	D.E.F. Consumption Gal/hr (l/h)	Mean Atmospheric Conditions
MAXIMUM POWER AND FUEL CONSUMPTION						
Rated Engine Speed—(PTO speed—1051 rpm)						
450.72 (336.10)	2100	24.83 (93.98)	0.387 (0.236)	18.16 (3.58)	1.88 (7.11)	
Standard Power Take-off Speed (1000 rpm)						
489.76 (365.22)	1998	26.36 (99.78)	0.378 (0.230)	18.58 (3.66)	1.87 (7.07)	
Maximum Power (1 hour)						
504.60 (376.28)	1900	27.07 (102.47)	0.377 (0.229)	18.64 (3.67)	1.81 (6.86)	

VARYING POWER AND FUEL CONSUMPTION

450.72 (336.10)	2100	24.83 (93.98)	0.387 (0.236)	18.16 (3.58)	1.88 (7.11)	Air temperature
388.05 (289.37)	2129	21.94 (83.06)	0.397 (0.242)	17.68 (3.48)	1.68 (6.38)	73°F (23°C)
293.26 (218.68)	2142	17.71 (67.03)	0.424 (0.258)	16.56 (3.26)	1.21 (4.58)	Relative humidity
196.37 (146.43)	2155	13.32 (50.42)	0.477 (0.290)	14.74 (2.90)	0.76 (2.88)	38%
98.87 (73.73)	2168	8.85 (33.50)	0.629 (0.383)	11.17 (2.20)	0.44 (1.66)	Barometer
3.84 (2.87)	2182	4.92 (18.64)	9.001 (5.475)	0.78 (0.15)	0.13 (0.49)	28.85" Hg (97.70 kPa)

Maximum torque - 1652 lb.-ft. (2240 Nm) at 1401 rpm

Maximum torque rise - 46.7%

Torque rise at 1681 engine rpm - 36%

Power increase at 1900 engine rpm - 12.0%

DRAWBAR PERFORMANCE FUEL CONSUMPTION CHARACTERISTICS

Power Hp (kW)	Drawbar pull lbs (kN)	Speed mph (km/h)	Crank- shaft speed rpm	Slip %	Fuel Consumption lb/hp.hr (kg/kW.h)	Hp.hr/gal (kW.h/l)	Temp. °F (°C) cool- ing med	Air dry bulb	Barom. inch Hg (kPa)
Maximum Power—4th Gear									
384.77 (286.92)	30580 (136.03)	4.72 (7.60)	2100	3.2	0.457 (0.278)	15.40 (3.03)	190 (88)	65 (18)	28.56 (96.72)
75% of Pull at Maximum Power—4th Gear									
297.59 (221.91)	22949 (102.08)	4.86 (7.82)	2134	1.8	0.484 (0.294)	14.52 (2.86)	185 (85)	68 (20)	28.58 (96.78)
50% of Pull at Maximum Power—4th Gear									
201.52 (150.27)	15317 (68.13)	4.93 (7.93)	2148	1.0	0.545 (0.331)	12.90 (2.54)	181 (83)	69 (20)	28.59 (96.82)
75% of Pull at Reduced Engine Speed—8th Gear									
297.29 (221.69)	22914 (101.93)	4.87 (7.83)	1405	1.8	0.421 (0.256)	16.69 (3.29)	175 (79)	68 (20)	28.59 (96.82)
50% of Pull at Reduced Engine Speed—8th Gear									
201.15 (149.99)	15310 (68.10)	4.93 (7.93)	1412	1.0	0.454 (0.276)	15.49 (3.05)	174 (79)	70 (21)	28.59 (96.82)

Location of tests: Nebraska Tractor Test Laboratory, University of Nebraska, Lincoln Nebraska 68583-0832

Dates of tests: September 20 - 24, 2013

Manufacturer: Case Corporation, 700 State Street Racine, Wi. 53404 USA.

CONSUMABLE Fluids, OIL and TIME: Fuel No. 2 Diesel **Specific gravity converted to 60°F (15°/15°C)** 0.8442 **Fuel weight** 7.029 lbs/gal (0.842 kg/l) **Diesel Exhaust Fluid (DEF)** 32% aqueous urea solution **DEF weight** 9.071 lbs/gal (1.087 kg/l) **Oil** SAE 15W40 **API service classification** CJ-4 **Transmission lubricant** Hytran Ultra Action fluid **Hydraulic and axle lubricant** Hytran Ultra Action fluid **Total time engine was operated** 17.5 hours

ENGINE: Make F.P.T. Diesel **Type** six cylinder vertical with turbocharger, air to air intercooler, and D.E.F. (diesel exhaust fluid) exhaust treatment **Serial No.** *A-002-209564* **Crankshaft** lengthwise **Rated engine speed** 2100 **Bore and stroke** 5.315" x 5.906" (135.0 mm x 150.0 mm) **Compression ratio** 15.5 to 1 **Displacement** 786 cu in (12880 ml) **Starting system** 24 volt **Lubrication** pressure **Air cleaner** two paper elements and aspirator **Oil filter** one full flow cartridge **Oil cooler** engine coolant heat exchanger for crankcase oil, radiator for hydraulic and front and rear axle, radiator for transmission oil **Fuel filter** two paper elements **Muffler** vertical **Cooling medium temperature control** thermostat and variable speed fan

ENGINE OPERATING PARAMETERS: **Fuel rate:** 165.2 - 177.2 lb/h (74.9 - 80.4 kg/h) **High idle:** 2165 - 2215 rpm **Turbo boost:** nominal 32.6 - 37.0 psi (225 - 255 kPa) as measured 33.8 psi (233 kPa)

CHASSIS: **Type** Tracklayer - rubber tracked **Serial No.** *ZDF134988* **Track width** rear 88.0" (2235 mm) front 88.0" (2235 mm) **Trackbase** 154.0" (3912 mm) **Length of track on ground** 29.4" (748 mm) **Hydraulic control system** direct engine drive **Transmission** selective gear fixed ratio with full range operator controlled powershift **Nominal travel speeds mph (km/h)** first 2.78 (4.47) second 3.34 (5.38) third 4.04 (6.50) fourth 4.87 (7.83) fifth 5.59 (8.99) sixth 6.14 (9.88) seventh 6.73 (10.83) eighth 7.39 (11.90) ninth 8.13 (13.08) tenth 8.93 (14.37) eleventh 9.79 (15.76) twelfth 10.76 (17.32) thirteenth 12.35 (19.88) fourteenth 14.88 (23.94) fifteenth 17.98 (28.93) sixteenth 21.64 (34.82) reverse 4.21 (6.77), 9.30 (14.97) **Clutch** multiple wet disc electro-hydraulically operated by foot pedal **Brakes** single wet disc hydraulically actuated by foot pedal **Steering** hydrostatic and articulated **Power take-off** 1000 rpm at 1998 engine rpm **Unladen tractor mass** 54290 lb (24625 kg)

DRAWBAR PERFORMANCE AT 2100 ENGINE RPM MAXIMUM POWER IN SELECTED GEARS

Power Hp (kW)	Drawbar pull lbs (kN)	Speed mph (km/h)	Crank- shaft speed rpm	Slip %	Fuel lb/hp.hr (kg/kW.h)	Consumption Hp.hr/gal (kW.h/l)	Temp.°F(°C) cool- ing med	Air dry bulb	Barom. inch Hg (kPa)
1st Gear									
323.66 (241.35)	50155 (233.10)	2.42 (3.89)	2121	13.9	0.514 (0.313)	13.67 (2.69)	185 (85)	62 (17)	28.54 (96.65)
2nd Gear									
367.31 (273.90)	44472 (197.82)	3.10 (4.99)	2103	7.7	0.477 (0.290)	14.73 (2.90)	188 (87)	59 (15)	28.53 (96.61)
3rd Gear									
380.90 (284.03)	37122 (165.12)	3.85 (6.20)	2100	4.9	0.461 (0.280)	15.26 (3.01)	189 (87)	64 (18)	28.56 (96.72)
4th Gear									
384.77 (286.92)	30580 (136.03)	4.72 (7.60)	2100	3.2	0.457 (0.278)	15.40 (3.03)	190 (88)	65 (18)	28.56 (96.72)
5th Gear									
381.69 (284.62)	26245 (116.74)	5.45 (8.77)	2100	2.6	0.459 (0.279)	15.32 (3.02)	196 (91)	78 (25)	28.48 (96.44)
6th Gear									
382.18 (284.99)	23789 (105.82)	6.02 (9.69)	2101	2.1	0.458 (0.279)	15.35 (3.02)	194 (90)	79 (26)	28.44 (96.31)
7th Gear									
380.91 (284.04)	21572 (95.96)	6.63 (10.66)	2099	1.7	0.457 (0.278)	15.37 (3.03)	196 (91)	79 (26)	28.45 (96.34)
8th Gear									
380.23 (283.54)	19539 (86.91)	7.30 (11.75)	2100	1.5	0.459 (0.279)	15.31 (3.02)	196 (91)	79 (26)	28.45 (96.34)
9th Gear									
375.50 (280.01)	17516 (77.91)	8.04 (12.94)	2099	1.2	0.467 (0.284)	15.07 (2.97)	193 (89)	79 (26)	28.44 (96.31)

REPAIRS AND ADJUSTMENTS: No repairs or adjustments.

Note 1: This tractor has a driveline protection system that limits the maximum engine torque in gears 1 and 2.

Note 2: The performance figures on this report are the result of replacing the electronic engine control module of the Case IH Quadtrac 450 with the Case IH Quadtrac 500 module.

REMARKS: All test results were determined from observed data obtained in accordance with official OECD, SAE and Nebraska test procedures. For the maximum power tests, the fuel temperature at the injection pump inlet was maintained at 110°F (43°C). The performance figures on this Summary were taken from a test conducted under the OECD Code 2 test procedure.

We, the undersigned, certify that this is a true and correct report of official Tractor Test No. **2073**, Nebraska Summary 891, December 2, 2013.

Roger M. Hoy
Director

M.F. Kocher
P.J. Jasa
J.D. Luck
Board of Tractor Test Engineers

TRACTOR SOUND LEVEL WITH CAB	dB(A)
At no load in 4th gear	75.6
Bystander in 15th Gear	89.2

TIRES, BALLAST AND WEIGHT

Rear tracks - no & size
Front tracks - no & size
Height of drawbar
Static weight with operator- Rear
- Front
- Total

Tested without ballast

2 x 30.0 in (762 mm)
2 x 30.0 in (762 mm)
20.5 in (520 mm)
23550 lb (10682 kg)
30915 lb (14023 kg)
54465 lb (24705 kg)

DRAWBAR PERFORMANCE AT 1900 ENGINE RPM **MAXIMUM POWER IN SELECTED GEARS**

Power Hp (kW)	Drawbar pull lbs (kN)	Speed mph (km/h)	Crank- shaft speed rpm	Slip %	Fuel Consumption lb/hp.hr (kg/kW.h)	Consumption Hp.hr/gal (kW.h/l)	Temp. °F(°C) cool- ing med	Air dry bulb	Barom. inch Hg (kPa)
323.13 (240.96)	50080 (222.76)	2.42 (3.89)	2118	13.8	1st Gear 0.514 (0.313)	13.68 (2.70)	185 (85)	62 (16)	28.54 (96.65)
365.83 (272.80)	49407 (219.77)	2.78 (4.47)	1968	11.6	2nd Gear 0.484 (0.294)	14.53 (2.86)	186 (85)	60 (16)	28.53 (96.61)
404.92 (301.95)	45831 (203.86)	3.32 (5.33)	1900	9.5	3rd Gear 0.474 (0.289)	14.82 (2.92)	182 (83)	65 (18)	28.56 (96.71)
421.29 (314.15)	37890 (168.54)	4.17 (6.71)	1899	5.4	4th Gear 0.454 (0.276)	15.48 (3.05)	182 (83)	67 (19)	28.58 (96.78)
421.67 (314.44)	32571 (144.88)	4.86 (7.81)	1900	4.1	5th Gear 0.454 (0.276)	15.47 (3.05)	183 (84)	78 (26)	28.48 (96.44)
425.24 (317.10)	29644 (131.86)	5.38 (8.66)	1899	3.3	6th Gear 0.451 (0.274)	15.59 (3.07)	190 (88)	79 (26)	28.44 (96.31)
424.72 (316.71)	26835 (119.37)	5.94 (9.55)	1899	2.6	7th Gear 0.449 (0.273)	15.64 (3.08)	184 (84)	79 (26)	28.44 (96.31)
425.65 (317.41)	24343 (108.28)	6.56 (10.56)	1901	2.1	8th Gear 0.448 (0.272)	15.69 (3.09)	183 (84)	79 (26)	28.45 (96.34)
425.07 (316.97)	22030 (97.99)	7.24 (11.65)	1900	1.7	9th Gear 0.450 (0.274)	15.61 (3.07)	184 (84)	79 (26)	28.44 (96.31)
422.22 (314.85)	19776 (87.97)	8.01 (12.88)	1908	1.4	10th Gear 0.451 (0.274)	15.60 (3.07)	183 (84)	79 (26)	28.44 (96.31)

HYDRAULIC PERFORMANCE

CATEGORY: IVN

Quick Attach: yes

OECD Static test

Maximum force exerted through whole range:	19728 lbs (87.8 kN)	
	Three outlet sets combined	
	<u>Standard pump</u>	<u>High flow pump</u>
i) Sustained pressure of the open relief valve:	2877 psi (198 bar)	3080 psi (212 bar)
ii) Pump delivery rate at minimum pressure and rated engine speed:	43.8 GPM (165.8 l/min)	58.9 GPM (222.9 l/min)
iii) Pump delivery rate at maximum hydraulic power:	43.3 GPM (163.7 l/min)	55.5 GPM (210.2 l/min)
Delivery pressure:	2526 psi (174 bar)	2675 psi (184 bar)
Power:	63.7 HP (47.5 kW)	86.7 HP (64.6 kW)
	Single outlet set	
ii) Pump delivery rate at minimum pressure and rated engine speed:	42.8 GPM (162.2 l/min)	47.5 GPM (179.7 l/min)
iii) Pump delivery rate at maximum hydraulic power:	42.7 GPM (161.6 l/min)	44.2 GPM (167.3 l/min)
Delivery pressure:	2024 psi (139 bar)	2161 psi (149 bar)
Power:	50.4 HP (37.6 kW)	55.7 HP (41.5 kW)

TwinFlow system

Two outlet sets combined

	<u>Standard pump</u>	<u>TwinFlow pump</u>
i) Sustained pressure at compensator cutoff:	2877 psi (198 bar)	2855 psi (197 bar)
ii) Pump delivery rate at minimum pressure and rated engine speed:	43.8 GPM (165.8 l/min)	57.3 GPM (217.0 l/min)
Combined flow:	101.1 GPM (382.8 l/min)	
iii) Pump delivery rate at maximum hydraulic power:	43.3 GPM (163.7 l/min)	56.4 GPM (213.6 l/min)
Delivery pressure:	2526 psi (174 bar)	2479 psi (171 bar)
Power:	63.7 HP (47.5 kW)	81.6 HP (60.9 kW)

Two outlet sets combined

	<u>High flow pump</u>	<u>TwinFlow pump</u>
i) Sustained pressure at compensator cutoff:	2993 psi (206 bar)	2855 psi (197 bar)
ii) Pump delivery rate at minimum pressure and rated engine speed:	61.0 GPM (230.9 l/min)	57.3 GPM (217.0 l/min)
Combined flow:	118.3 GPM (447.9 l/min)	
iii) Pump delivery rate at maximum hydraulic power:	56.7 GPM (214.7 l/min)	56.4 GPM (213.6 l/min)
Delivery pressure:	2517 psi (174 bar)	2479 psi (171 bar)
Power:	83.3 HP (62.1 kW)	81.6 HP (60.9 kW)

HITCH DIMENSIONS AS TESTED - NO LOAD

	inch	mm
A	32.6	827
B	29.9	760
C	23.2	590
D	22.0	558
E	13.5	342
F	13.4	340
G	35.0	890
*G'	11.8	300
H	4.6	117
I	22.8	578
J	21.6	550
K	29.0	736
L	56.3	1431
*L'	63.6	1615
M	34.3	871
N	46.5	1181
O	7.9	200
P	45.4	1154
Q	40.9	1039
R	38.5	978

*G' to undercarriage pivot point

*L' to Quick coupler ends

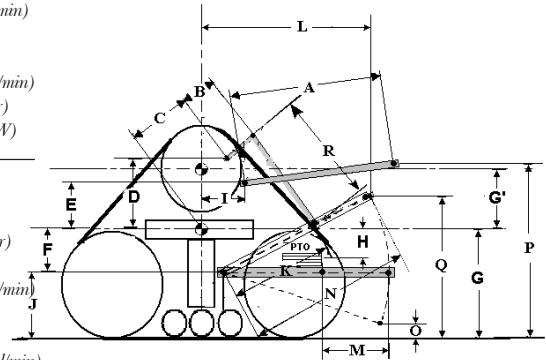

Case IH Quadtrac 500 Diesel

Institute of Agriculture and Natural Resources
University of Nebraska-Lincoln