

University of Nebraska - Lincoln

DigitalCommons@University of Nebraska - Lincoln

Nebraska Tractor Tests

Tractor Test and Power Museum, The Lester F.
Larsen

2016

Test 2149A: Case IH Magnum 340 RowTrac

Nebraska Tractor Test Lab

University of Nebraska-Lincoln, tractortestlab@unl.edu

Follow this and additional works at: <https://digitalcommons.unl.edu/tractormuseumlit>



Part of the [Energy Systems Commons](#), [History of Science, Technology, and Medicine Commons](#), [Other Mechanical Engineering Commons](#), [Physical Sciences and Mathematics Commons](#), [Science and Mathematics Education Commons](#), and the [United States History Commons](#)

Nebraska Tractor Test Lab, "Test 2149A: Case IH Magnum 340 RowTrac" (2016). *Nebraska Tractor Tests*. 2617.

<https://digitalcommons.unl.edu/tractormuseumlit/2617>

This Article is brought to you for free and open access by the Tractor Test and Power Museum, The Lester F. Larsen at DigitalCommons@University of Nebraska - Lincoln. It has been accepted for inclusion in Nebraska Tractor Tests by an authorized administrator of DigitalCommons@University of Nebraska - Lincoln.

NEBRASKA OECD TRACTOR TEST 2149A—SUMMARY 1012A

CASE IH MAGNUM 340 ROWTRAC DIESEL

17 SPEED

POWER TAKE-OFF PERFORMANCE

Power HP (kW)	Crank shaft speed rpm	Diesel Consumption		D.E.F. Consumption		Mean Atmospheric Conditions
		Gal/hr (l/h)	lb/hp.hr (kg/kW.h)	Hp.hr/gal (kW.h/l)	Gal/hr (l/h)	
MAXIMUM POWER AND FUEL CONSUMPTION						
Rated Engine Speed—(PTO speed—1109 rpm)						
302.71 (225.73)	2000	15.60 (59.05)	0.361 (0.220)	19.41 (3.82)	1.90 (7.17)	
Standard Power Take-off Speed (998 rpm)						
340.17 (253.66)	1800	17.07 (64.62)	0.352 (0.214)	19.93 (3.93)	2.03 (7.70)	
Maximum Power (1 hour)						
340.17 (253.66)	1800	17.07 (64.62)	0.352 (0.214)	19.93 (3.93)	2.03 (7.70)	

VARYING POWER AND FUEL CONSUMPTION

302.71 (225.73)	2000	15.60 (59.05)	0.361 (0.220)	19.41 (3.82)	1.90 (7.17)	Air temperature
271.97 (202.81)	2115	14.53 (55.01)	0.374 (0.228)	18.72 (3.69)	1.60 (6.07)	73°F (23°C)
207.34 (154.62)	2148	11.72 (44.35)	0.396 (0.241)	17.70 (3.49)	1.07 (4.03)	Relative humidity
140.18 (104.53)	2178	8.80 (33.31)	0.440 (0.268)	15.93 (3.14)	0.68 (2.57)	37%
71.35 (53.21)	2213	5.91 (22.39)	0.581 (0.353)	12.07 (2.38)	0.41 (1.56)	Barometer
0.86 (0.64)	2227	2.96 (11.22)	24.279 (14.768)	0.29 (0.06)	0.33 (1.26)	28.96" Hg (98.05 kPa)

Maximum torque - 1154 lb.-ft. (1565 Nm) at 1400 rpm
 Maximum torque rise - 45.2%
 Torque rise at 1600 engine rpm - 38%
 Power increase at 1800 engine rpm - 12.4%

DRAWBAR PERFORMANCE

UNBALLASTED - FRONT DRIVE ENGAGED FUEL CONSUMPTION CHARACTERISTICS

Power Hp (kW)	Drawbar pull lbs (kN)	Speed mph (km/h)	Crank- shaft speed rpm	Slip %	Fuel Consumption lb/hp.hr (kg/kW.h)	D.E.F. Consumption Hp.hr/gal (kW.h/l)	D.E.F. Consumption lb/hp.hr (kg/kW.h)	Temp. °F(°C) cool- ing med	Air dry bulb	Barom. inch Hg (kPa)
Power at Rated Engine Speed—7th Gear										
251.58 (187.60)	18957 (84.32)	4.98 (8.01)	2000	3.5	0.435 (0.265)	16.11 (3.17)	0.065 (0.039)	209 (98)	55 (13)	28.63 (96.95)
75% of Pull at Rated Engine Speed—7th Gear										
204.52 (152.51)	14258 (63.42)	5.38 (8.66)	2131	2.0	0.465 (0.283)	15.08 (2.97)	0.057 (0.035)	206 (96)	60 (15)	28.68 (97.12)
50% of Pull at Rated Engine Speed—7th Gear										
140.34 (104.65)	9513 (42.31)	5.53 (8.90)	2171	1.1	0.527 (0.321)	13.30 (2.62)	0.049 (0.030)	192 (89)	60 (16)	28.69 (97.16)
75% of Pull at Reduced Engine Speed—10th Gear										
204.18 (152.25)	14310 (63.65)	5.35 (8.61)	1397	2.0	0.425 (0.259)	16.47 (3.25)	0.060 (0.037)	202 (94)	60 (15)	28.68 (97.12)
50% of Pull at Reduced Engine Speed—10th Gear										
140.37 (104.67)	9477 (42.15)	5.55 (8.93)	1437	1.1	0.454 (0.276)	15.45 (3.04)	0.062 (0.038)	187 (86)	60 (16)	28.69 (97.16)

Location of tests: Nebraska Tractor Test Laboratory, University of Nebraska, Lincoln, Nebraska 68583-0832

Dates of tests: April 19 to May 2, 2016

Manufacturer: CNH America LLC, 700 State St. Racine, WI 53404 USA

CONSUMABLE Fluids, OIL and TIME: Fuel No. 2 Diesel **Specific gravity converted to 60°/60°F (15°/15°C)** 0.8417 **Fuel weight** 7.008 lbs/gal (0.840 kg/l) **Diesel Exhaust Fluid (DEF)** 32% aqueous urea solution **DEF weight** 9.071 lbs/gal (1.087 kg/l) **Oil** SAE 10W40 **API service classification** CJ-4 **Transmission and hydraulic lubricant** Case IH Akcela Hy-Tran Ultratractor fluid **Front axle lubricant** SAE 85W-140 API GL-5 **Total time engine was operated:** 16.0 hours

ENGINE: Make F.P.T. Diesel **Type** six cylinder vertical with turbocharger, air to air intercooler and D.E.F. (diesel exhaust fluid) exhaust treatment. **Serial No.** *15H00119172* **Crankshaft** lengthwise **Rated engine speed** 2000 **Bore and stroke** 4.606" x 5.315" (117.0 mm x 135.0 mm) **Compression ratio** 15.9 to 1 **Displacement** 531 cu in (8704 ml) **Starting system** 12 volt **Lubrication** pressure **Air cleaner** two paper elements and aspirator **Oil filter** one full flow cartridge **Oil cooler** engine coolant heat exchanger for crankcase oil, radiator for hydraulic and transmission oil **Fuel filter** two paper elements **Fuel cooler** radiator for pump return fuel **Exhaust** DOC (diesel oxidation catalyst) and SCR (selective catalyst reduction) integrated within a vertical muffler **Cooling medium temperature control** thermostat and variable speed fan

ENGINE OPERATING PARAMETERS: Fuel rate: 107.1 - 114.0 lb/h (48.6 - 51.7 kg/h) **High idle:** 2215 - 2265 rpm **Turbo boost:** nominal 23.2 - 26.1 psi (160 - 180 kPa) as measured 24.2 psi (167 kPa)

CHASSIS: Type Half track drive, front wheel assist with rear rubber tracks **Serial No.** *ZGRE01076* **Tread width** rear 120.0" (3050 mm) front 68.0" (1725 mm) to 88.0" (2235 mm) **Wheelbase** 124.2" (3155 mm) **Length of track on ground** 29.4" (748 mm) **Hydraulic control system** direct engine drive **Transmission** selective gear fixed ratio with full range operator controlled powershift **Nominal travel speeds mph (km/h)** first 2.23 (3.59) second 2.56 (4.12) third 2.95 (4.75) fourth 3.39 (5.45) fifth 3.88 (6.25) sixth 4.46 (7.17) seventh 5.20 (8.37) eighth 5.97 (9.60) ninth 6.88 (11.07) tenth 7.89 (12.69) eleventh 9.05 (14.56) twelfth 10.38 (16.70) thirteenth 12.93 (20.81) fourteenth 14.83 (23.87) fifteenth 17.11 (27.53) sixteenth 19.01 (30.60) seventeenth 19.01 (30.60) electronically limited reverse 3.21 (5.17), 3.68 (5.93), 7.48 (12.04), 8.58 (13.81)

**DRAWBAR PERFORMANCE
UNBALLASTED - FRONT DRIVE ENGAGED
MAXIMUM POWER IN SELECTED GEARS**

Power Hp (kW)	Drawbar pull lbs (kN)	Speed mph (km/h)	Crank- shaft speed rpm	Slip %	Fuel Consumption lb/hp.hr (kg/kW.h)	Hp.hr/gal (kW.h/l)	D.E.F. Consumption lb/hp.hr (kg/kW.h)	Temp. °F(°C) cool- ing med	Air dry bulb	Barom. inch Hg (kPa)
					3rd Gear					
227.94 (169.97)	33754 (150.14)	2.54 (4.08)	2010	13.9	0.486 (0.296)	14.41 (2.84)	0.072 (0.044)	202 (94)	47 (8)	28.85 (97.70)
					4th Gear					
239.04 (178.25)	29275 (130.22)	3.06 (4.92)	2000	8.8	0.461 (0.280)	15.22 (3.00)	0.070 (0.043)	208 (98)	51 (11)	28.90 (97.87)
					5th Gear					
244.49 (182.31)	25419 (113.07)	3.61 (5.81)	1999	6.3	0.450 (0.274)	15.59 (3.07)	0.068 (0.042)	206 (97)	54 (12)	28.92 (97.93)
					6th Gear					
246.30 (183.67)	21893 (97.38)	4.22 (6.79)	1999	4.5	0.446 (0.271)	15.73 (3.10)	0.067 (0.041)	209 (98)	55 (13)	28.63 (96.95)
					7th Gear					
251.58 (187.60)	18957 (84.32)	4.98 (8.01)	2000	3.5	0.435 (0.265)	16.11 (3.17)	0.065 (0.039)	209 (98)	55 (13)	28.63 (96.95)
					8th Gear					
249.20 (185.82)	16245 (72.26)	5.75 (9.25)	2000	2.7	0.441 (0.268)	15.88 (3.13)	0.065 (0.039)	209 (98)	55 (13)	28.63 (96.95)
					9th Gear					
247.25 (184.37)	13888 (61.78)	6.68 (10.74)	2000	2.0	0.443 (0.269)	15.82 (3.12)	0.066 (0.040)	209 (98)	57 (14)	28.64 (96.99)
					10th Gear					
244.25 (182.14)	11905 (52.96)	7.70 (12.38)	2000	1.5	0.450 (0.274)	15.58 (3.07)	0.066 (0.040)	209 (98)	57 (14)	28.64 (96.99)
					11th Gear					
239.46 (178.56)	10142 (45.11)	8.86 (14.25)	1999	1.2	0.460 (0.280)	15.25 (3.00)	0.067 (0.041)	210 (99)	58 (14)	28.66 (97.05)

Clutch multiple wet disc electrohydraulically operated by foot pedal **Brakes** wet disc hydraulically operated by two foot pedals that can be locked together **Steering** hydrostatic **Power take-off** 1000 rpm at 1803 engine rpm **Unladen tractor mass** 36170 lb (16406 kg)

REPAIRS AND ADJUSTMENTS: No repairs or adjustments.

NOTE: The data on this summary was obtained from testing conducted on the New Holland T8.410 Smarttrax Diesel.

REMARKS: All test results were determined from observed data obtained in accordance with official OECD, SAE and Nebraska test procedures. The manufacturer's remote flow claims of 59 GPM (224 l/min), with High flow system, and 75 GPM (282 l/min), with TwinFlow system, were not verified. The performance results on this summary were taken from a test conducted under the OECD Code 2 test procedure.

We, the undersigned, certify that this is a true and correct report of official Tractor Test No. **2149A**, Nebraska Summary 1012A, June 10, 2016.

Roger M. Hoy
Director

M.F. Kocher
J.D. Luck
P.J. Jasa
Board of Tractor Test Engineers

TRACTOR SOUND LEVEL WITH CAB	Front Wheel Drive	
	Engaged dB(A)	Disengaged dB(A)
At no load in 6th gear	67.4	67.6
Bystander in 15th gear		89.3

TIRES AND WEIGHT

Rear Tracks - No. & size
Front Tires - No., size, ply & psi (kPa)
Height of Drawbar
Static Weight with operator - Rear
- Front
- Total

Tested Without Ballast
2 x 18 in (455 mm)
Two 420/85R38;***;17(115)
22.5 in (570 mm)
26685 lb (12104 kg)
9660 lb (4381 kg)
36345 lb (16485 kg)

DRAWBAR PERFORMANCE AT 1800 ENGINE RPM
UNBALLASTED - FRONT DRIVE ENGAGED
MAXIMUM POWER IN SELECTED GEARS

Power Hp (kW)	Drawbar pull lbs (kN)	Speed mph (km/h)	Crank- shaft speed rpm	Slip %	Fuel Consumption lb/hp.hr (kg/kW.h)	Consumption Hp.hr/gal (kW.h/l)	D.E.F. Consumption lb/hp.hr (kg/kW.h)	Temp. °F(°C) cool- ing med	Air dry bulb	Barom. inch Hg (kPa)
3rd Gear										
229.15 (170.87)	33792 (150.31)	2.55 (4.10)	2012	13.6	0.485 (0.295)	14.45 (2.85)	0.072 (0.044)	199 (93)	47 (8)	28.85 (97.70)
4th Gear										
243.89 (181.87)	32017 (142.42)	2.86 (4.60)	1933	11.9	0.471 (0.287)	14.86 (3.93)	0.070 (0.043)	209 (98)	52 (11)	28.89 (97.83)
5th Gear										
259.83 (193.75)	30056 (133.70)	3.25 (5.22)	1873	10.1	0.458 (0.279)	15.29 (3.01)	0.066 (0.040)	210 (99)	55 (13)	28.90 (97.87)
6th Gear										
269.40 (200.89)	27652 (123.00)	3.65 (5.87)	1800	8.1	0.445 (0.271)	15.74 (3.10)	0.065 (0.040)	209 (98)	57 (14)	28.92 (97.93)
7th Gear										
281.20 (209.69)	24041 (106.94)	4.39 (7.06)	1800	5.4	0.428 (0.260)	16.37 (3.22)	0.062 (0.038)	210 (99)	55 (13)	28.63 (96.95)
8th Gear										
282.85 (210.92)	20790 (92.48)	5.10 (8.21)	1800	4.1	0.425 (0.258)	16.50 (3.25)	0.061 (0.037)	210 (99)	55 (13)	28.63 (96.95)
9th Gear										
282.45 (210.62)	17804 (79.20)	5.95 (9.58)	1800	2.9	0.425 (0.259)	16.48 (3.25)	0.061 (0.037)	210 (99)	57 (14)	28.64 (96.99)
10th Gear										
280.96 (209.51)	15333 (68.20)	6.87 (11.06)	1800	2.3	0.427 (0.260)	16.42 (3.23)	0.062 (0.038)	210 (99)	57 (14)	28.64 (96.99)
11th Gear										
277.95 (207.27)	13156 (58.52)	7.92 (12.75)	1799	1.7	0.432 (0.263)	16.22 (3.20)	0.062 (0.037)	209 (98)	58 (14)	28.66 (97.05)
12th Gear										
273.34 (203.83)	11235 (49.97)	9.12 (14.68)	1799	1.4	0.439 (0.267)	15.98 (3.15)	0.062 (0.038)	210 (99)	58 (14)	28.66 (97.05)

HYDRAULIC PERFORMANCE

CATEGORY: 4N

Quick Attach: Yes

OECD Static test

Maximum force exerted through whole range:	20012 lbs (89.0 kN)
	Standard pump
	<u>three outlet sets combined</u>
i) Sustained pressure at compensator cutoff:	2814 psi (194 bar)
ii) Pump delivery rate at minimum pressure and rated engine speed:	44.2 GPM (167.2 l/min)
iii) Pump delivery rate at maximum hydraulic power:	45.1 GPM (170.6 l/min)
Delivery pressure:	2608 psi (180 bar)
Power:	68.6 HP (51.1 kW)
	<u>single outlet set</u>
i) Sustained pressure at compensator cutoff:	2803 psi (193 bar)
ii) Pump delivery rate at minimum pressure and rated engine speed:	42.6 GPM (161.3 l/min)
iii) Pump delivery rate at maximum hydraulic power:	33.8 GPM (127.8 l/min)
Delivery pressure:	2250 psi (155 bar)
Power:	44.3 HP (33.0 kW)

HITCH DIMENSIONS AS TESTED—NO LOAD

	inch	mm
A	29.7	755
B	20.5	520
C	22.9	581
D	23.4	595
E	13.2	336
F	11.6	295
G	33.8	860
*G'	14.6	370
H	0.8	20
I	20.9	530
J	22.2	565
K	30.2	768
L	53.1	1350
*L'	60.4	1534
M	27.2	691
N	38.2	970
O	10.4	265
P	49.8	1265
Q	42.3	1075
R	40.7	1035

*G' to undercarriage pivot point
*L' to Quick coupler ends

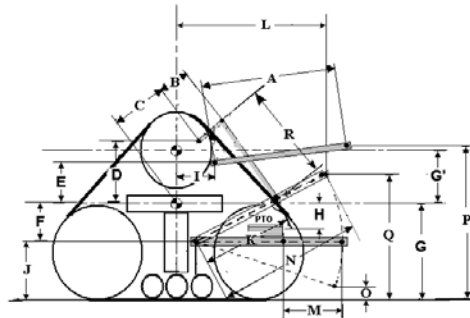

CASE IH MAGNUM 340 ROWTRAC DIESEL