

University of Nebraska - Lincoln

DigitalCommons@University of Nebraska - Lincoln

---

Nebraska Tractor Tests

Tractor Test and Power Museum, The Lester F.  
Larsen

---

2022

## Tractor Test 2253: John Deere 9RX 590

Nebraska Tractor Test Lab

University of Nebraska-Lincoln, tractortestlab@unl.edu

Follow this and additional works at: <https://digitalcommons.unl.edu/tractormuseumlit>



Part of the [Energy Systems Commons](#), [History of Science, Technology, and Medicine Commons](#), [Other Mechanical Engineering Commons](#), [Physical Sciences and Mathematics Commons](#), [Science and Mathematics Education Commons](#), and the [United States History Commons](#)

---

Nebraska Tractor Test Lab, "Tractor Test 2253: John Deere 9RX 590" (2022). *Nebraska Tractor Tests*. 3519.

<https://digitalcommons.unl.edu/tractormuseumlit/3519>

This Article is brought to you for free and open access by the Tractor Test and Power Museum, The Lester F. Larsen at DigitalCommons@University of Nebraska - Lincoln. It has been accepted for inclusion in Nebraska Tractor Tests by an authorized administrator of DigitalCommons@University of Nebraska - Lincoln.

# NEBRASKA OECD TRACTOR TEST 2253-SUMMARY 1213

## JOHN DEERE 9RX 590 DIESEL

### 18 SPEED

#### POWER TAKE-OFF PERFORMANCE

Power HP (kW)	Crank shaft speed rpm	Diesel Consumption		D.E.F. Consumption		Mean Atmospheric Conditions
		Gal/hr (l/h)	lb/hp.hr (kg/kW.h)	Hp.hr/gal (kW/h/l)	Gal/hr (l/h)	
<b>MAXIMUM POWER AND FUEL CONSUMPTION</b>						
SEE NOTE 1 - PAGE 2						
<b>Rated Engine Speed—(PTO speed—1109 rpm)</b>						
320.69 (239.14)	2099	18.65 (70.60)	0.410 (0.249)	17.19 (3.39)	0.83 (3.13)	Fuel used during active exhaust regeneration-1.04 gal (3.93 l) (see note 2, p.2)
<b>Standard Power Take-off Speed(1000 rpm)</b>						
366.82 (273.54)	1895	20.19 (76.43)	0.388 (0.236)	18.17 (3.58)	0.63 (2.38)	
<b>Maximum Power (1 hour)</b>						
368.66 (274.91)	1749	19.72 (74.66)	0.377 (0.229)	18.69 (3.68)	0.64 (2.43)	

#### VARYING POWER AND FUEL CONSUMPTION

320.69 (239.14)	2099	18.65 (70.60)	0.410 (0.249)	17.19 (3.39)	0.83 (3.13)	Air temperature
279.13 (208.15)	2150	17.00 (64.35)	0.429 (0.261)	16.42 (3.23)	0.73 (2.75)	73°F (23°C)
209.70 (156.37)	2150	13.93 (52.72)	0.468 (0.285)	15.06 (2.97)	0.55 (2.09)	Relative humidity
139.84 (104.28)	2150	11.31 (42.82)	0.570 (0.347)	12.36 (2.44)	0.46 (1.74)	46%
69.78 (52.03)	2150	8.35 (31.61)	0.843 (0.513)	8.36 (1.65)	0.30 (1.12)	Barometer
1.36 (1.01)	2150	5.67 (21.47)	29.459 (17.919)	0.24 (0.05)	0.42 (1.60)	28.54" Hg (96.64 kPa)

Maximum Torque - 1184 lb-ft (1605 Nm) at 1550 rpm  
 Maximum Torque Rise -47.5%  
 Torque rise at 1679 engine rpm - 43%  
 Power increase at 1749 engine rpm - 15.0%

#### DRAWBAR PERFORMANCE (Unballasted) FUEL CONSUMPTION CHARACTERISTICS

Power Hp (kW)	Drawbar pull lbs (kN)	Speed mph (km/h)	Crank- shaft speed rpm	Slip %	Fuel Consumption lb/hp.hr (kg/kW.h)	D.E.F. Consumption Hp.hr/gal (kW/h/l)	Temp. °F (°C)	cool- ing med	Air dry bulb	Barom. inch Hg (kPa)
<b>Power at Rated Engine Speed—7th Gear- Manual mode</b>										
453.54 (338.20)	34076 (151.58)	4.99 (8.03)	2100	4.1	0.437 (0.266)	16.12 (3.17)	0.019 (0.012)	207 (97)	63 (17)	28.90 (97.87)
<b>75% of Pull at Rated Engine Speed—7th Gear- Manual mode</b>										
356.44 (265.79)	25548 (113.64)	5.23 (8.42)	2167	2.6	0.449 (0.273)	15.70 (3.09)	0.021 (0.013)	206 (97)	70 (21)	28.72 (97.26)
<b>50% of Pull at Rated Engine Speed—7th Gear- Manual mode</b>										
243.05 (181.24)	17029 (75.75)	5.35 (8.61)	2189	1.3	0.491 (0.298)	14.36 (2.83)	0.029 (0.018)	205 (96)	71 (22)	28.71 (97.22)
<b>75% of Pull at Reduced Engine Speed—5.3 mph (8.6 km/h)-Auto mode</b>										
356.64 (265.95)	25564 (113.71)	5.23 (8.42)	1433	2.6	0.391 (0.238)	18.02 (3.55)	0.031 (0.019)	205 (96)	71 (22)	28.71 (97.22)
<b>50% of Pull at Reduced Engine Speed—5.3 mph (8.6 km/h)-Auto mode</b>										
243.33 (181.45)	17230 (76.64)	5.30 (8.53)	1433	1.4	0.420 (0.256)	16.76 (3.30)	0.024 (0.015)	200 (93)	72 (22)	28.71 (97.22)

**Location of tests:** Nebraska Tractor Test Laboratory, University of Nebraska, Lincoln, Nebraska 68583-0832

**Dates of tests:** May 23 to June 8, 2022

**Manufacturer:** John Deere Tractor Works, 3500 East Donald St., P.O. Box 270, Waterloo Ia, 50704-0270

**CONSUMABLE Fluids, OIL and TIME: Fuel** No. 2 Diesel **Specific gravity converted to 60°/60°F (15°/15°C)** 0.8463 **Fuel weight** 7.047 lbs/gal (0.845 kg/l) **Diesel Exhaust Fluid (DEF)** 32% aqueous urea solution **DEF weight** 9.071 lbs/gal (1.087 kg/l) **Oil SAE 10W-30 API service classification CK-4** **Transmission, hydraulic and final drive lubricant** John Deere Hy-Gard fluid **Total time engine was operated:** 24.0 hours

**ENGINE: Make** John Deere **Diesel Type** six cylinder vertical with two turbochargers, air to air aftercooler and D.E.F. (diesel exhaust fluid) exhaust treatment **Serial No.** \*RG6136U000749\* **Crankshaft** lengthwise **Rated engine speed** 2100 **Bore and stroke** 5.197" x 6.496" (132.0 mm x 165.0 mm) **Compression ratio** 15.9 to 1 **Displacement** 826 cu in (13548 ml) **Starting system** 12 volt **Lubrication** pressure **Air cleaner** two paper elements and aspirator **Oil filter** one full flow cartridge **Oil cooler** radiator for crankcase oil, radiator for transmission/hydraulic oil also feeding front and rear axles **Fuel filter** two paper cartridges **Fuel cooler** radiator for returned fuel **Exhaust** DOC (diesel oxidation catalyst) and SCR (selective catalyst reduction) integrated within a vertical muffler **Cooling medium temperature control** 1 thermostat and variable speed fan

**ENGINE OPERATING PARAMETERS: Fuel rate:** Stationary PTO operation (390 engine hp) 124.7 - 135.1 lb/h (56.5 - 61.3 kg/h), Drawbar operations (540 engine hp) 174.8 - 189.4 lb/h (79.3 - 85.9 kg/h) (590 engine hp) 190.9 - 206.8 lb/h (86.6 - 93.8 kg/h) **High idle:** 2150 - 2250 rpm (2125 - 2175 rpm with PTO engaged) **Turbo boost:** (590 engine hp) nominal 32.5 - 36.9 psi (225 - 255 kPa) as measured 35.5 psi (245 kPa)

**CHASSIS: Type** 4WD with rubber tracks **Serial No.** \*1RW9590DENJ820127\* **Track width** rear 88.0" (2235 mm) front 88.0" (2235 mm) **Wheelbase** 163.5" (4154 mm) **Length of track on ground** 72.4" (1839 mm) **Hydraulic control system** direct engine drive **Transmission** selective gear fixed ratio with full range operator controlled power shift **Nominal travel speeds mph (km/h)** first 2.52 (4.06) second 3.12 (5.02) third 3.44 (5.53) fourth 3.85 (6.20) fifth 4.24 (6.82) sixth 4.75 (7.65) seventh 5.24 (8.43) eighth 5.82 (9.37) ninth 6.46 (10.40) tenth 7.19 (11.57) eleventh 7.92 (12.74) twelfth 8.71 (14.02) thirteenth 9.77 (15.73) fourteenth 10.75 (17.30)

**DRAWBAR PERFORMANCE**  
**(Unballasted at 2100 engine rpm, Manual mode)**

**MAXIMUM POWER IN SELECTED GEARS**

Power Hp (kW)	Drawbar pull lbs (kN)	Speed mph (km/h)	Crank- shaft speed rpm	Slip %	Fuel Consumption lb/hp.hr (kg/kW.h)	D.E.F. Consumption lb/hp.hr (kg/kW.h)	Temp. °F(°C) cool- ing med	Air dry bulb	Barom. inch Hg (kPa)	
1st Gear										
925.62 (242.81)	55193 (245.51)	2.22 (3.56)	2153	14.0	0.521 (0.317)	13.53 (2.67)	0.027 (0.016)	206 (97)	55 (13)	28.79 (97.49)
2nd Gear										
373.69 (278.66)	50643 (225.27)	2.77 (4.46)	2097	10.6	0.487 (0.296)	14.48 (2.85)	0.025 (0.015)	206 (96)	56 (13)	28.79 (97.49)
3rd Gear										
398.17 (296.92)	48755 (216.87)	3.07 (4.93)	2102	10.4	0.475 (0.289)	14.83 (2.92)	0.023 (0.014)	205 (96)	60 (16)	28.64 (96.99)
4th Gear										
425.05 (316.96)	45823 (203.83)	3.48 (5.60)	2101	9.2	0.466 (0.283)	15.13 (2.98)	0.022 (0.013)	206 (97)	61 (16)	28.64 (96.99)
5th Gear										
433.35 (323.15)	41714 (185.55)	3.90 (6.27)	2099	7.5	0.459 (0.279)	15.36 (3.03)	0.021 (0.013)	206 (97)	64 (18)	28.64 (96.99)
6th Gear										
446.30 (332.80)	37314 (165.98)	4.49 (7.22)	2099	5.1	0.445 (0.271)	15.83 (3.12)	0.019 (0.012)	205 (96)	58 (14)	28.73 (97.29)
7th Gear										
453.54 (338.20)	34076 (151.58)	4.99 (8.03)	2100	4.1	0.437 (0.266)	16.12 (3.17)	0.019 (0.012)	207 (97)	63 (17)	28.90 (97.87)
8th Gear										
455.37 (339.57)	30481 (135.59)	5.60 (9.01)	2100	3.2	0.435 (0.265)	16.19 (3.19)	0.019 (0.012)	207 (97)	64 (18)	28.91 (97.90)
9th Gear										
455.02 (339.30)	27276 (121.33)	6.26 (10.07)	2099	2.5	0.436 (0.265)	16.16 (3.18)	0.020 (0.012)	207 (97)	64 (18)	28.90 (97.87)
10th Gear										
453.27 (338.00)	24314 (108.15)	6.99 (11.25)	2098	2.0	0.437 (0.266)	16.11 (3.17)	0.020 (0.012)	207 (97)	64 (18)	28.89 (97.83)
11th Gear										
456.19 (340.18)	22125 (98.42)	7.73 (12.44)	2099	1.7	0.434 (0.264)	16.23 (3.20)	0.021 (0.013)	207 (97)	63 (17)	28.88 (97.80)
12th Gear										
454.80 (339.14)	19997 (88.95)	8.53 (13.72)	2099	1.4	0.434 (0.264)	16.22 (3.20)	0.021 (0.013)	207 (97)	63 (17)	28.88 (97.80)

**TRACTOR SOUND LEVEL WITH CAB**

**dB(A)**

At no load in 6th gear	72.3
Transport speed- no load- 18th gear	77.5
Bystander in 18th gear	92.0

Horizontal distance of drawbar hitch point behind rear wheel axis - 54.2"(1377 mm), 60.1"(1527 mm)

**TRACKS AND WEIGHT**

**Rear tracks - no & size**  
**Front tracks - no & size**  
**Height of drawbar**  
**Static weight with operator- Rear**  
**- Front**  
**- Total**

**Tested Without Ballast**

2 x 30.0 in (760 mm)  
2 x 30.0 in (760 mm)  
21.0 in (545 mm)  
25905 lb (11750 kg)  
32825 lb (14889 kg)  
58730 lb (26639 kg)

fifteenth 13.29 (21.38) sixteenth 16.40 (26.39)  
seventeenth 20.10 (32.34) eighteenth 24.78 (39.90)  
reverse 2.52 (4.06), 3.44 (5.53), 3.85 (6.20), 5.24  
(8.43), 5.82 (9.37), 7.92 (12.74) **Clutch** wet multiple  
disc hydraulically actuated by foot pedal **Brakes**  
wet multiple disc hydraulically actuated by foot  
pedal **Steering** hydrostatic and articulated **Power**  
**take-off** 1000 rpm at 1895 engine rpm **Unladen**  
**tractor mass** 58555 lb (26560 kg)

**REPAIRS AND ADJUSTMENTS:** No repairs  
or adjustments.

**NOTE 1.** In stationary PTO operation, this  
model operates in a derated power mode. With  
stationary PTO operation, using FieldCruise™,  
an isochronous governor is utilized. All PTO tests  
were conducted with FieldCruise™ engaged.

**NOTE 2.** The manufacturer declares that the  
average time between active regenerations is over  
50 hours. No power change was observed during  
the active regeneration.

**NOTE 3:** The John Deere 9RX 590 T.E.C.U.  
(Tractor Electronic Control Unit) is compliant  
with ISOBUS 11783.

**NOTE 4:** This tractor has a driveline protection  
system that limits the maximum engine torque in  
gears 1 through 3.

**REMARKS:** All test results were determined  
from observed data obtained in accordance with  
official OECD, SAE and Nebraska test procedures.  
This tractor fell 0.1% short meeting the  
manufacturer's remote hydraulic flow claim of  
58.0 GPM (219 l/min). The manufacturer's remote  
hydraulic flow claim of 115.0 GPM (435 l/min) with  
dual pumps was not verified. The manufacturer's  
remote hydraulic flow claim of 42.0 GPM (159 l/  
min) with the optional 3/4" coupler set was not  
verified. The performance figures on this summary  
were taken from a test conducted under the OECD  
Code 2 test procedure.

We, the undersigned, certify that this is a true  
and correct report of official Tractor Test No.  
**2253**, Nebraska Summary 1213, December 2, 2022.

Roger M. Hoy  
Director

P.J. Jasa  
J.D. Luck  
S. Pitla  
Board of Tractor Test Engineers

**DRAWBAR PERFORMANCE**  
**UNBALLASTED - AUTO MODE**  
**(Loads based on 2100 engine rpm manual mode performance runs)**  
**DRAWBAR POWER AT SELECTED TRAVEL SPEEDS**

Power Hp (kW)	Drawbar pull lbs (kN)	Speed mph (km/h)	Crank- shaft speed rpm	Slip %	Fuel Consumption lb/hp.hr (kg/kW.h)	Hp.hr/gal (kW.h/l)	D.E.F. Consumption lb/hp.hr (kg/kW.h)	Temp. °F (°C) cool- ing med	Air dry bulb	Barom. inch Hg (kPa)
4.2 mph (6.8 km/h)										
433.29 (323.10)	41304 (183.73)	3.94 (6.33)	1541	7.6	0.412 (0.251)	17.11 (3.37)	0.027 (0.016)	206 (97)	66 (19)	28.64 (96.97)
4.7 mph (7.6 km/h)										
446.25 (332.77)	37070 (164.90)	4.51 (7.26)	1723	5.1	0.407 (0.247)	17.33 (3.41)	0.024 (0.014)	205 (96)	60 (16)	28.73 (97.29)
5.2 mph (8.4 km/h)										
453.20 (337.95)	33690 (149.86)	5.05 (8.12)	1718	4.1	0.406 (0.247)	17.34 (3.42)	0.023 (0.014)	206 (97)	64 (18)	28.90 (97.87)
5.7 mph (9.2 km/h)										
454.87 (339.19)	30581 (136.03)	5.58 (8.98)	1694	3.2	0.404 (0.246)	17.44 (3.44)	0.023 (0.014)	206 (97)	64 (18)	28.90 (97.87)
6.5 mph (10.4 km/h)										
454.17 (338.67)	27207 (121.02)	6.26 (10.07)	1558	2.6	0.392 (0.239)	17.96 (3.54)	0.026 (0.016)	207 (97)	64 (18)	28.90 (97.85)
7.2 mph (11.6 km/h)										
453.34 (338.06)	24210 (107.69)	7.02 (11.30)	1738	2.0	0.400 (0.243)	17.63 (3.47)	0.024 (0.015)	207 (97)	64 (18)	28.89 (97.83)
7.8 mph (12.6 km/h)										
455.20 (339.44)	22018 (97.94)	7.76 (12.48)	1705	1.7	0.404 (0.246)	17.44 (3.44)	0.026 (0.016)	207 (97)	63 (17)	28.88 (97.80)
8.7 mph (14.0 km/h)										
454.04 (338.58)	19915 (88.59)	8.55 (13.76)	1704	1.4	0.399 (0.243)	17.67 (3.48)	0.027 (0.016)	206 (97)	63 (17)	28.88 (97.80)

**DRAWBAR PERFORMANCE**  
**(Unballasted at 1800 ENGINE RPM, Manual mode)**  
**MAXIMUM POWER IN SELECTED GEARS**

Power Hp (kW)	Drawbar pull lbs (kN)	Speed mph (km/h)	Crank- shaft speed rpm	Slip %	Fuel Consumption lb/hp.hr (kg/kW.h)	Hp.hr/gal (kW.h/l)	D.E.F. Consumption lb/hp.hr (kg/kW.h)	Temp.°F(°C) cool- ing med	Air dry bulb	Barom. inch Hg (kPa)
1st Gear										
328.20 (244.74)	55031 (244.79)	2.24 (3.60)	2154	13.1	0.511 (0.311)	13.80 (2.72)	0.026 (0.016)	206 (97)	55 (13)	28.80 (97.51)
2nd Gear										
378.33 (282.12)	52018 (231.39)	2.73 (4.39)	2083	11.2	0.487 (0.296)	14.48 (2.85)	0.021 (0.013)	205 (96)	54 (12)	28.74 (97.31)
3rd Gear										
409.41 (305.29)	51052 (227.09)	3.01 (4.84)	2079	10.9	0.471 (0.286)	14.97 (2.95)	0.020 (0.012)	205 (96)	56 (13)	28.74 (97.32)
4th Gear										
427.61 (318.87)	47391 (210.87)	3.39 (5.45)	2079	10.7	0.469 (0.285)	15.03 (2.96)	0.021 (0.013)	206 (97)	62 (17)	28.64 (96.99)
5th Gear										
450.98 (336.30)	46220 (205.60)	3.66 (5.89)	2027	10.0	0.457 (0.278)	15.40 (3.03)	0.021 (0.013)	207 (97)	64 (18)	28.64 (96.99)
6th Gear										
484.17 (361.04)	46051 (204.84)	3.95 (6.35)	1910	8.3	0.436 (0.265)	16.16 (3.18)	0.022 (0.013)	205 (96)	58 (14)	28.73 (97.29)
7th Gear										
496.27 (370.07)	43809 (194.87)	4.25 (6.84)	1852	7.5	0.424 (0.258)	16.63 (3.28)	0.023 (0.014)	205 (96)	61 (16)	28.73 (97.29)
8th Gear										
504.28 (376.04)	40520 (180.24)	4.67 (7.52)	1800	5.9	0.415 (0.253)	16.97 (3.34)	0.024 (0.014)	205 (96)	56 (13)	28.66 (97.05)
9th Gear										
508.32 (379.05)	36314 (161.53)	5.25 (8.45)	1800	4.6	0.412 (0.251)	17.10 (3.37)	0.023 (0.014)	205 (96)	56 (13)	28.65 (97.02)
10th Gear										
510.32 (380.55)	32457 (144.38)	5.90 (9.50)	1800	3.7	0.410 (0.249)	17.19 (3.39)	0.023 (0.014)	205 (96)	57 (14)	28.65 (97.02)
11th Gear										
515.64 (384.51)	29564 (131.51)	6.54 (10.53)	1800	3.0	0.406 (0.247)	17.35 (3.42)	0.023 (0.014)	205 (96)	57 (14)	28.65 (97.02)
12th Gear										
518.82 (386.88)	26914 (119.72)	7.23 (11.64)	1800	2.6	0.404 (0.246)	17.45 (3.44)	0.023 (0.014)	205 (96)	59 (15)	28.65 (97.00)
13th Gear										
511.68 (381.56)	23551 (104.76)	8.15 (13.12)	1799	2.0	0.409 (0.249)	17.21 (3.39)	0.023 (0.014)	205 (96)	59 (15)	28.64 (96.99)

**Lugging ability in 11th gear**

Crankshaft speed rpm	2099	1999	1900	1801	1700	1600	1399	1105
Pull-lbs (kN)	22074 (98.19)	25579 (113.78)	27744 (123.41)	29609 (131.71)	31253 (139.02)	31981 (142.26)	31409 (139.71)	29485 (131.15)
Increase in pull%	0	16	26	34	42	45	42	34
Power-Hp (kW)	455.57 (339.71)	500.00 (372.85)	513.10 (382.62)	517.62 (385.99)	513.96 (383.26)	494.24 (368.55)	425.06 (316.96)	316.16 (235.76)
Speed-mph (km/h)	7.74 (12.46)	7.33 (11.80)	6.94 (11.16)	6.56 (10.55)	6.17 (9.93)	5.80 (9.33)	5.07 (8.16)	4.02 (6.47)
Slip %	1.6	2.1	2.5	2.8	3.2	3.4	3.2	2.8

## HYDRAULIC PERFORMANCE

CATEGORY: 4N/4

Quick Attach: Yes

OECD Static test

	<u>Category 4N</u>	<u>lift cylinders</u>
Maximum force exerted through whole range:	15648 lbs(69.6 kN)	(1 x 90 mm and 1x100 mm)
	20965 lbs(93.3 kN)	(2 x 110 mm)
	<u>Category 4</u>	
	15501 lbs(69.0 kN)	(1 x 90 mm and 1x100 mm)
	20527 lbs(91.3 kN)	(2 x 110 mm)
	<u>three outlet sets combined</u>	
i) Sustained pressure at compensator cutoff:	2874 psi	(198 bar)
ii) Pump delivery rate at minimum pressure and rated engine speed:	57.9 GPM	(219.3 l/min)
iii) Pump delivery rate at maximum hydraulic power:	58.7 GPM	(222.1 l/min)
Delivery pressure:	2468 psi	(170 bar)
Power:	84.5 HP	(63.0 kW)
	<u>single outlet set - 1/2" couplers</u>	
i) Sustained pressure at compensator cutoff:	2874 psi	(198 bar)
ii) Pump delivery rate at minimum pressure and rated engine speed:	37.0 GPM	(140.2 l/min)
iii) Pump delivery rate at maximum hydraulic power:	34.9 GPM	(132.3 l/min)
Delivery pressure:	2286 psi	(158 bar)
Power:	46.6 HP	(34.7 kW)

### Category 4N

	inch	mm	inch	mm
A	30.7	780	29.9	760
B	19.7	500	19.7	500
C	34.8	885	34.8	885
D	28.7	730	28.7	730
E	18.7	475	18.7	475
F	12.5	318	12.5	318
G	33.1	842	33.1	842
*G'	19.5	495	19.5	495
H	2.2	57	2.2	57
I	28.8	733	28.8	733
J	20.6	524	20.6	524
K	30.9	785	30.9	785
L	52.8	1342	52.8	1342
*L'	58.7	1491	59.6	1515
M	14.7	374	14.7	374
N	45.6	1159	45.6	1159
O	9.0	230	9.0	230
P	47.6	1210	47.6	1210
Q	40.6	1032	40.4	1027
R	49.6	1260	48.6	1260

\*G' to undercarriage pivot point

\*L' to Quick Attach ends

### HITCH DIMENSIONS AS TESTED—NO LOAD

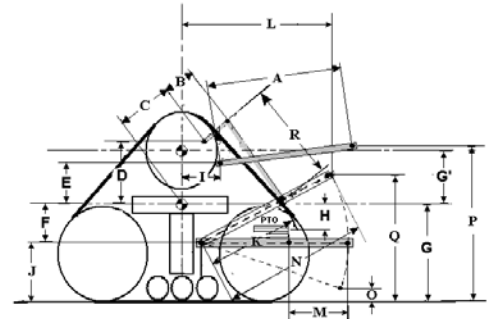

### RECOMMENDED CITATION FORMAT:

NTTL.(2022). Nebraska OECD Tractor test 2253 for John Deere 9RX 590 Diesel. Lincoln, NE:Nebraska Tractor Test Laboratory. Retrieved from <http://tractortestlab.unl.edu>



**JOHN DEERE 9RX 590 DIESEL**