

University of Nebraska - Lincoln

DigitalCommons@University of Nebraska - Lincoln

---

Proceedings of the North American Prairie  
Conferences

North American Prairie Conference

---

1989

## Landscape Design Awards

Follow this and additional works at: <http://digitalcommons.unl.edu/napcproceedings>



Part of the [International and Area Studies Commons](#)

---

"Landscape Design Awards" (1989). *Proceedings of the North American Prairie Conferences*. 36.  
<http://digitalcommons.unl.edu/napcproceedings/36>

This Article is brought to you for free and open access by the North American Prairie Conference at DigitalCommons@University of Nebraska - Lincoln. It has been accepted for inclusion in Proceedings of the North American Prairie Conferences by an authorized administrator of DigitalCommons@University of Nebraska - Lincoln.

# LANDSCAPE DESIGN AWARDS

## Commercial/Industrial Honor Award

The Office of Peter Walker and Martha Swartz  
San Francisco, California  
Westlake/Southlake Master Plan

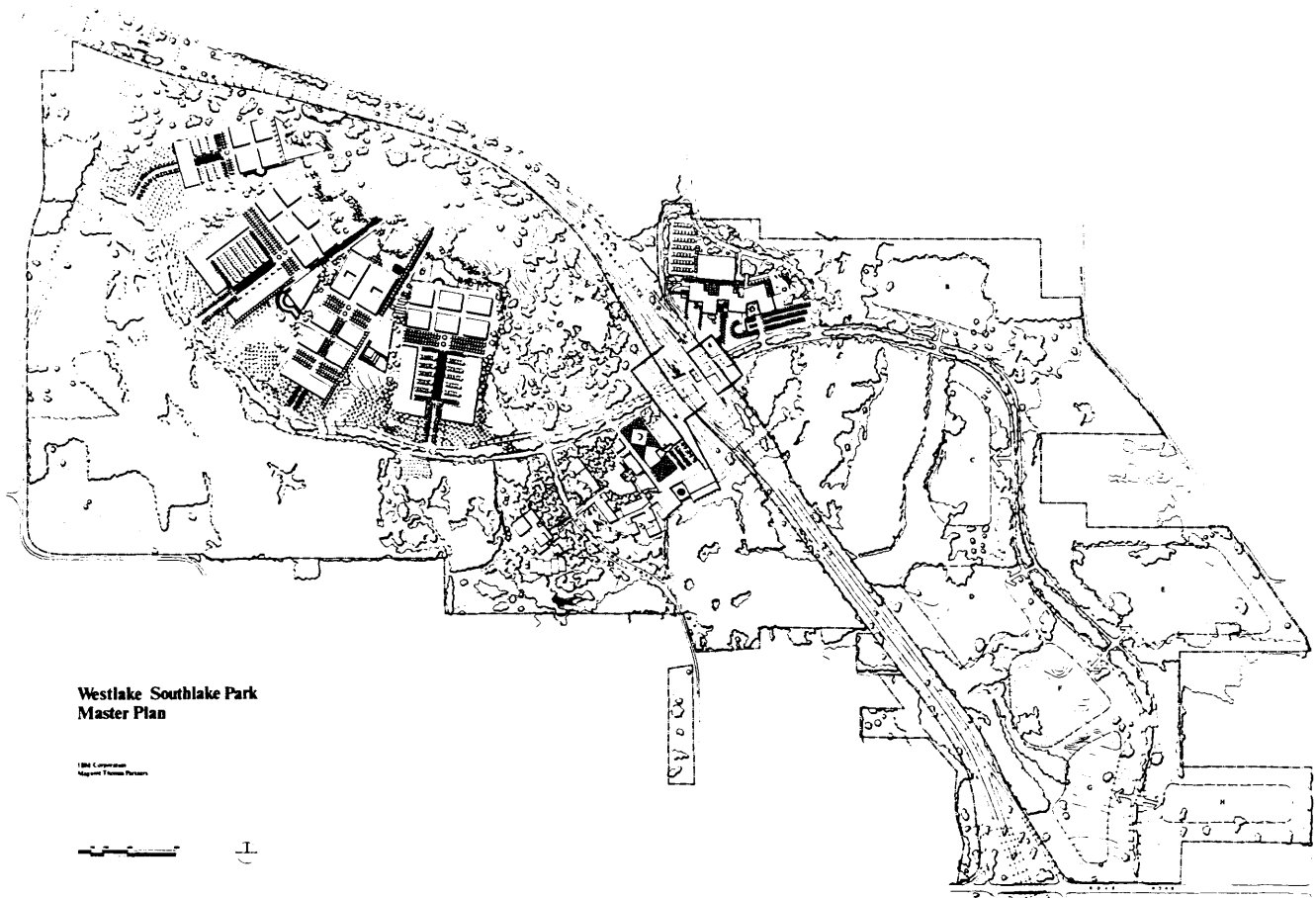

### *Jury's Comments:*

"A huge project with imaginative concept in which prairie is a small but important part of project."

"Project may be too big conceptually for simply a prairie context, though it is really a fine example of sensitive corporate planning, incorporating prairie preservation/restoration."

"The masterplan compacts development and restores a natural environment, while creating a liveable environment."

"Agriculture is an aesthetic context as well as a land use; prairie aspects center on restoring degraded pasture for upgrading landscape quality and sustainability."

Prairie in many areas apparently to be used as long-term temporary cover crop."

**Commercial/Institution Merit Award**

Environmental Survey Consulting, Austin, TX  
David Mahler, July Walther  
Robert J. Anderson Landscape Architect  
Schlumberger Well Services, Inc., Austin, TX

Seven Acres of Mid-Grass Prairie Restoration Landscaping  
at the Schlumberger Well Services Office Complex  
Austin, Texas

David Mahler and Judy Walther  
Environmental Survey Consulting  
4602 Placid Place  
Austin, Texas 78731

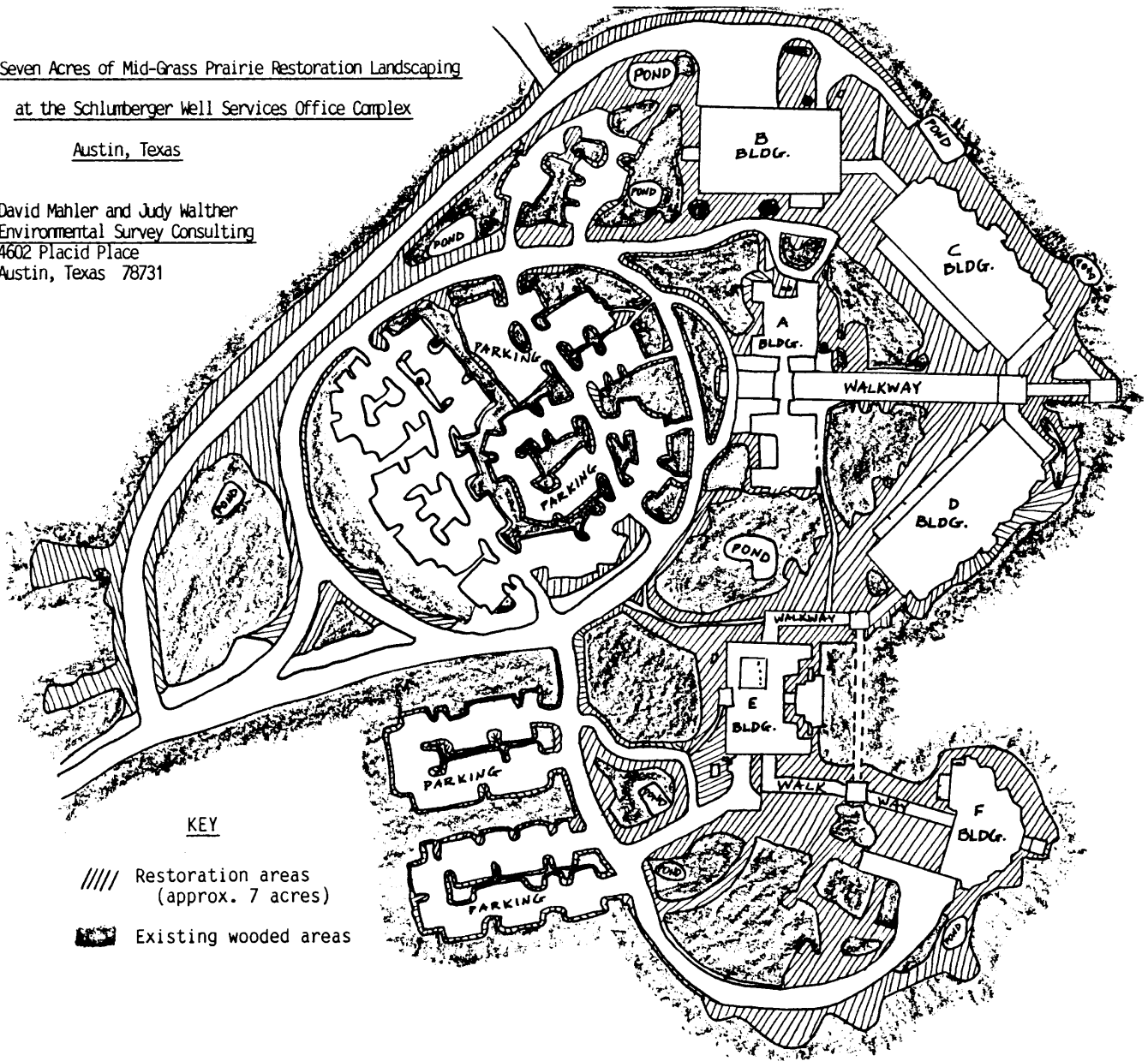

*Jury's Comments:*

“Careful attention to detail and the site’s intimate character returned it to the character of original prairie savannah.”  
“Knowledge of the ecosystem and environment translates into tremendous success of planting, especially when integrated with maintenance. Design, installation and maintenance well integrated into an overall process. We applaud use of a range of sizes and planting methods (plants and

seedlings) for native plant material in this environment. Immediate success in prairie plantings such as this are too often overlooked as a good public relations tool.”  
“Parking clustered in woods preserved existing vegetation and minimized site disturbance.”  
“Research, design, installation and maintenance were well-integrated into an overall process.”

**Public Landscape Honor Award**

Missouri Department of Natural Resources  
 Division of Parks and Recreation  
 Prairie State Park Master Plan  
 Barton Company, MO

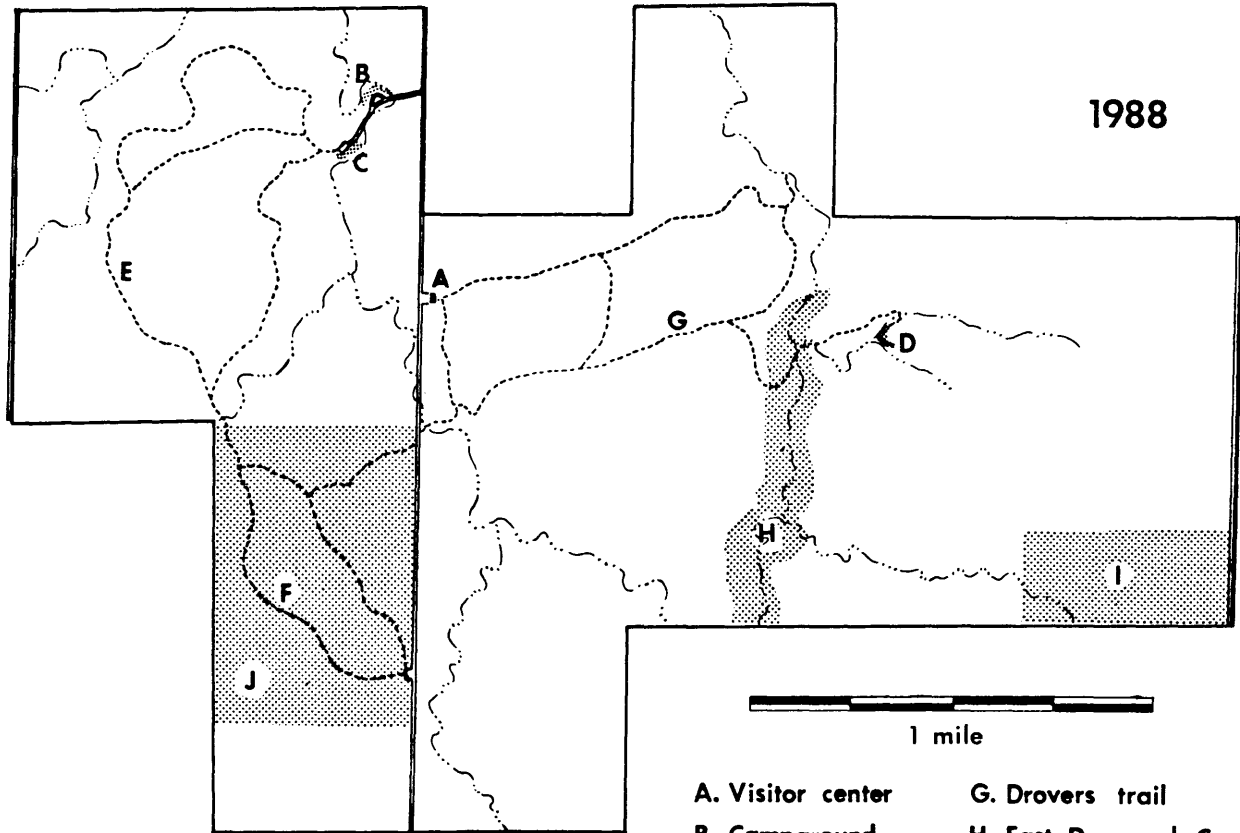

- |                            |   |
|----------------------------|---|
| <b>A. Visitor center</b>   | <b>G. Drivers trail</b>                       |
| <b>B. Campground</b>       | <b>H. East Drywood Creek<br/>Natural Area</b> |
| <b>C. Picnic area</b>      | <b>I. Tzi-Sho Natural Area</b>                |
| <b>D. Backpack camp</b>    | <b>J. Regal Prairie Natural<br/>Area</b>      |
| <b>E. Coyote trail</b>     |   |
| <b>F. Gayfeather trail</b> |   |

PRAIRIE STATE PARK  
 LIBERAL, MISSOURI

*Jury's Comments:*

“The planners understood the visual impact of man and his creations in a prairie landscape. Therefore, limiting the group usage is commendable and necessary to preserve the prairie and the prairie experience as is the foresight to remove traces of man’s development to create the open sweep of a prairie. The change to ‘experience’ the prairie is great, even better than learning about or interpreting the prairie. Here you can live it.”

“Research is reflected in plan documentation; management and preservation are also well-integrated. We applaud the explicit forethought accorded research and management. This coordination is commendable.”

“The combination of private and public land acquisition looks like a difficult but key ingredient to overall success.”

“Well-stated and carefully followed objectives.”

“Submitted material apparently lacks documentation of process for accommodating physical design elements.”

“We question the safety of bison/man interaction.”

**Student Honor Award**

Laurence Lamb  
 Kitchener, Ontario, Canada  
 Prairie Fringe

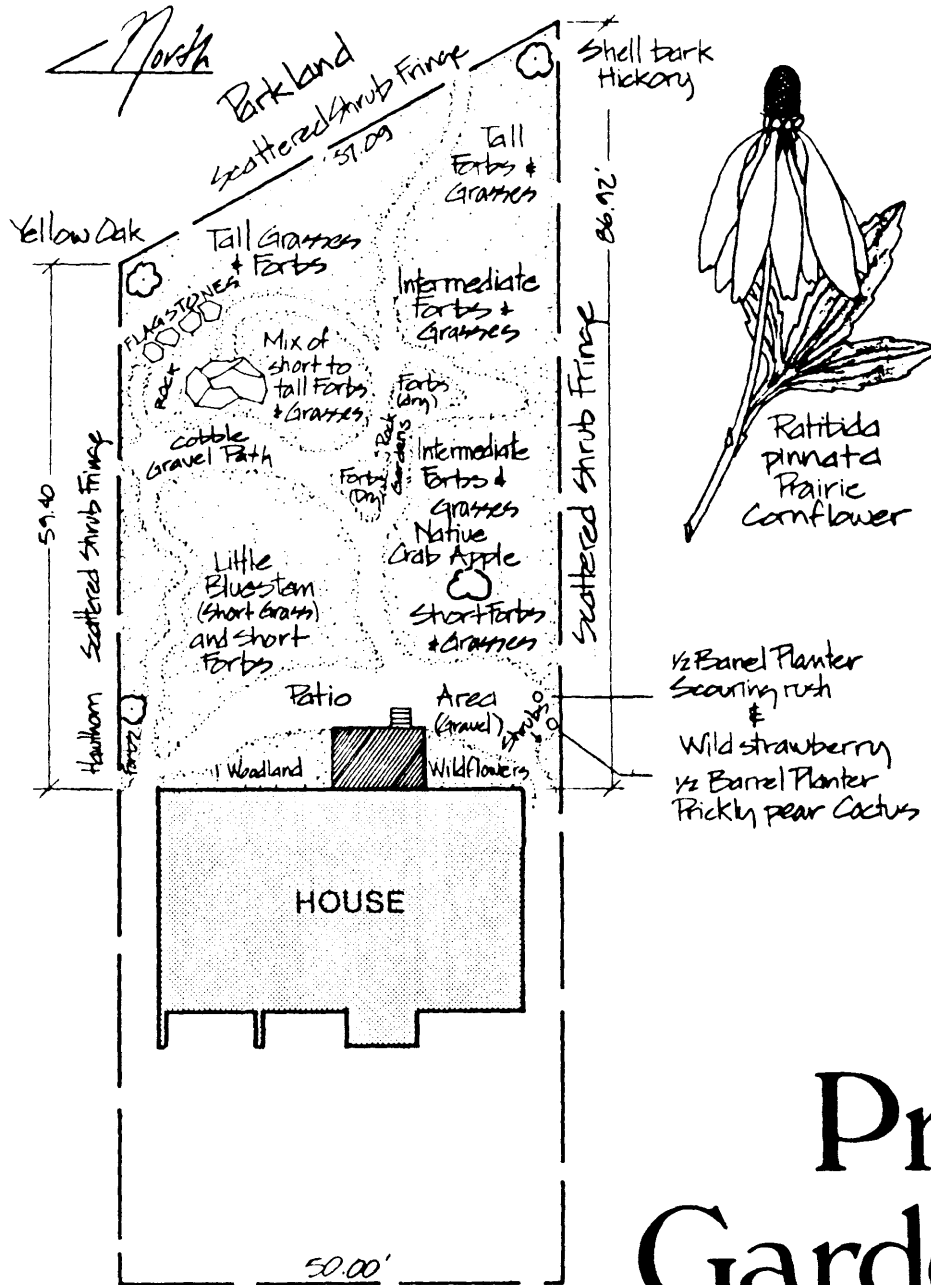

# Prairie Garden

*Jury's Comments:*

"We appreciate the realization that it is not 'low maintenance' to establish a prairie garden but obviously a great learning process, showing dedication to implementation."  
 "Hard to perceive the overall character of the project. Needed an eye level shot or aerial shot."  
 "The design created a prairie 'oasis' but a collection of prairie plants does not create a prairie; probably better understood simply as a prairie garden."

"234 species, 63 rare collection of plants - extreme north - 7 year's work; a major objective is to attract butterflies, but needs more explicit objectives."  
 "Mix is a prairie arboretum garden/collection - very positive."  
 "Use of boulder as focal point very important."

**Non-Professional Honor Award**

Patricia K. Armstrong  
 Naperville, IL  
 Prairie Sun

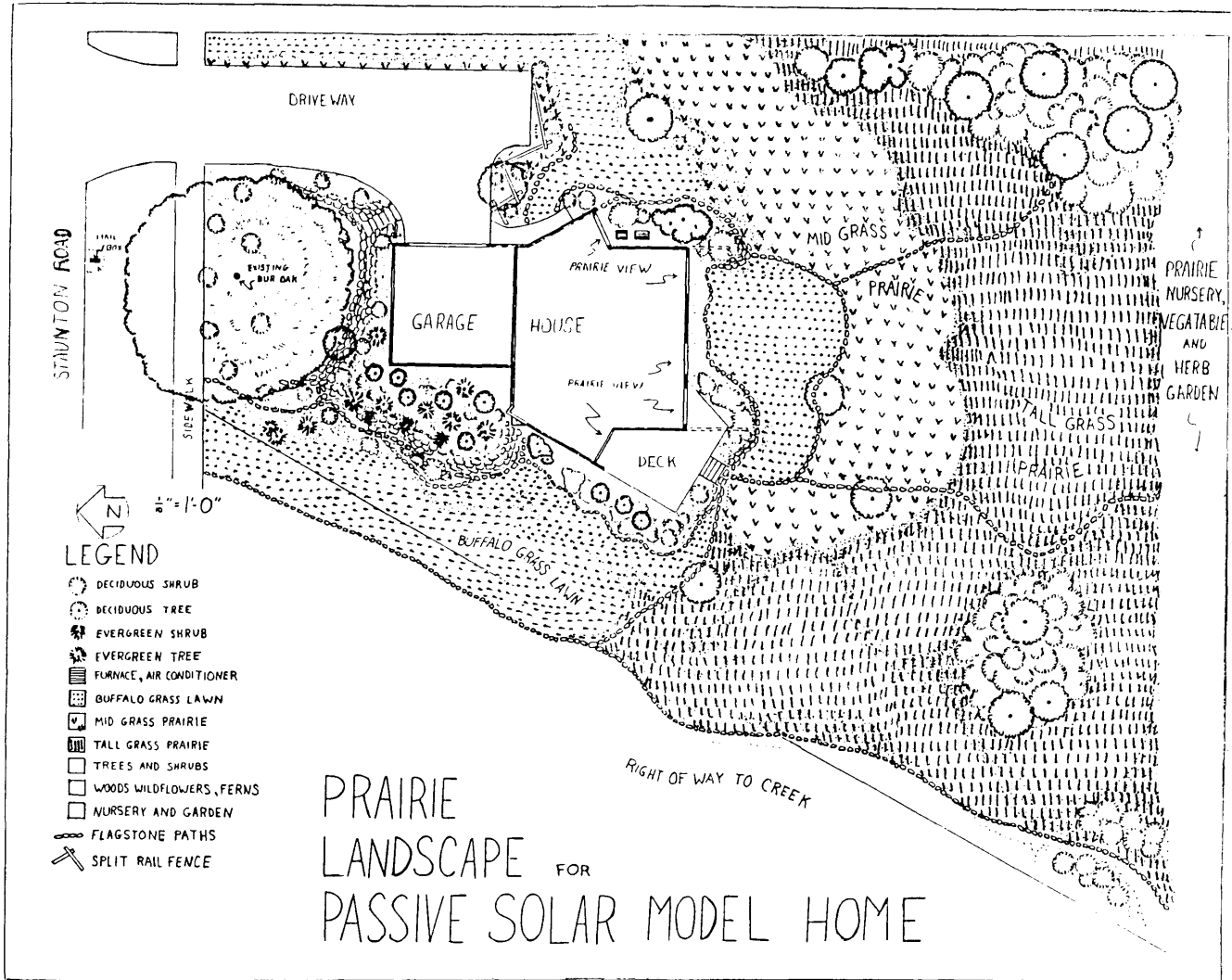

*Jury's Comments:*

“A lot of variety in material but well-placed in a small area. Good attention to detail throughout—stone paths, down spouts, etc. Unique ‘foundation plantings’ help to conceal utilities. Over-planting for dramatic early effect may need to be dealt with later. Excellent use of plants in their niches. Variety of plants well-contained within a space. Concept clear, well thought out, well executed. Plantings conceived to deal with climate, microclimate and screening. Nice layering of plant material.”

List of Jury

- Richard K. Sutton, ASLA, UN-L, Department of Horticulture
- Deon Bahr, AIA, Principal, BVH Ltd.
- Art Thompson, Jr., ASLA, Nebraska Department of Roads